

STEP 1 TID Pump Protector

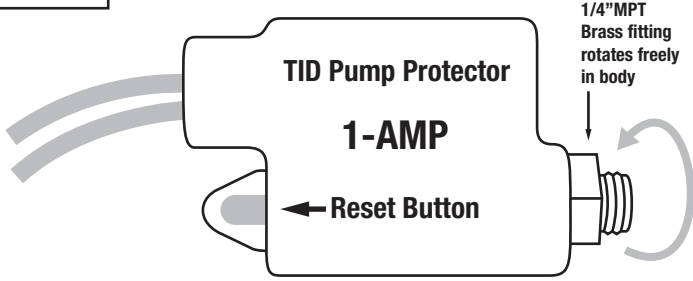

Español - Protector de la bomba hecha por TID

STEP 2 Disconnect main power before installing protector

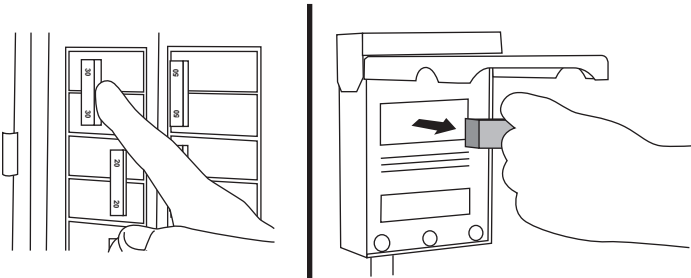

Español - Desconecte la electricidad principal antes de instalar el protector

STEP 3 Tools and materials required

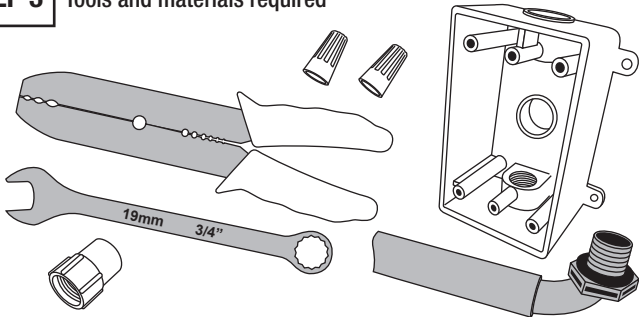

Español - Herramientas y materiales requeridos

STEP 4 Apply thread tape and install protector

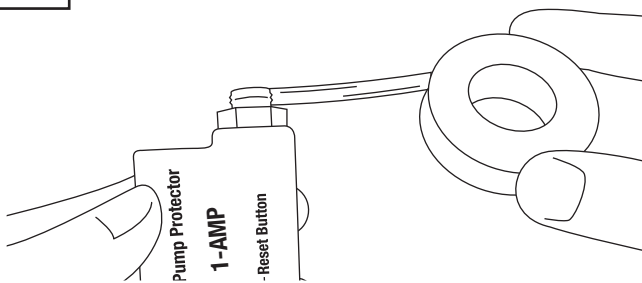

Español - Aplique cinta de roscas e instale protector

STEP 5 Hold protector while threading in brass fitting

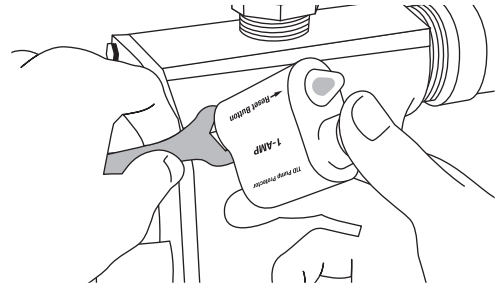

Español - Agarre el protector mientras enrosca la parte de bronce la cual gira

STEP 6 Protect wiring with flexible conduit and fittings

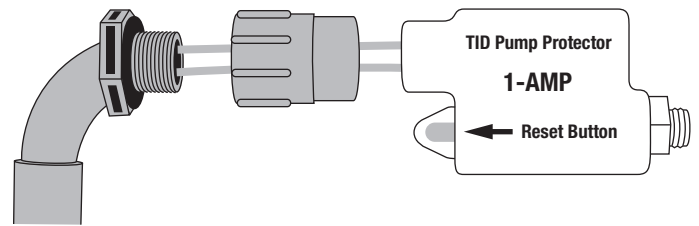

Español - Proteja el cableado con cunducto flexible

STEP 7 Connect 1-Amp Protector's wiring to motor-starter circuit or pump control panel

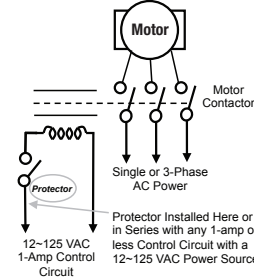

12-125 VAC,
1-Amp Control Circuits

Note: Control panel connections not shown due to panel variations; please refer to your specific control panel's instructions or wiring diagrams to ensure proper connection.

Español - Conecté los cables del protector de 1 ampere al circuito de la marcha del motor o al panel de control de bomba

STEP 8 Push reset button until it locks in the run position

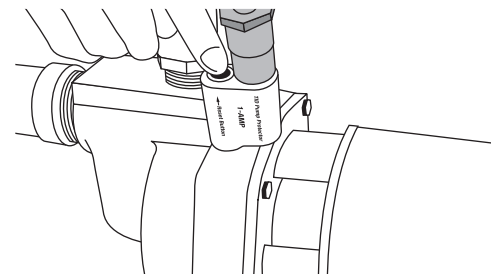

Español - Presione el botón de reinicio hasta que encaje

STEP 9 Restore main power

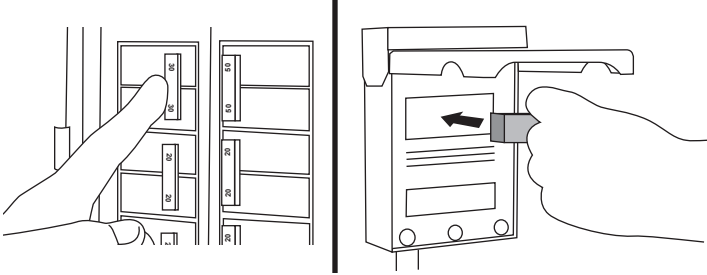

Español - Restablezca la corriente principal

STEP 10 When the pump overheats (Approx. 137°F / 58°C), the reset button will activate, which stops the pump motor

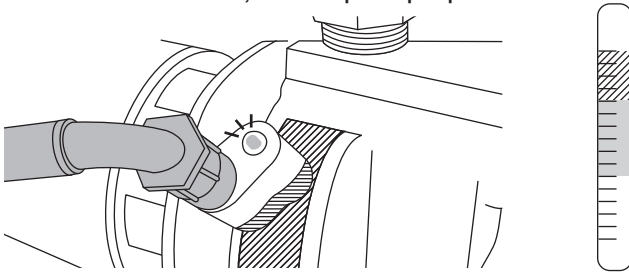

Español - Cuando se sobrecalienta la bomba (aproximadamente 137-F / 58-C) el protector desconectara la electricidad al motor

STEP 11 Disconnect main power before beginning repair

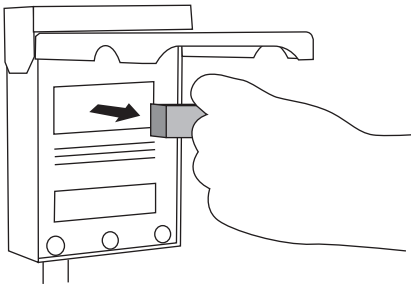

Español - Desconecte la electricidad principal antes de comenzar la reparación

STEP 12 Identify and repair the cause of overheating



1. Loss of Prime



3. Broken Suction Line



2. Blocked or Restricted Suction



4. Welded Contacts

Español - Identificar y reparar la causa del sobrecalentamiento: pérdida de succión; bloqueados o restringidos de succión; tubería rota; contactos soldados

STEP 13 Prime / prepare the pump for restart

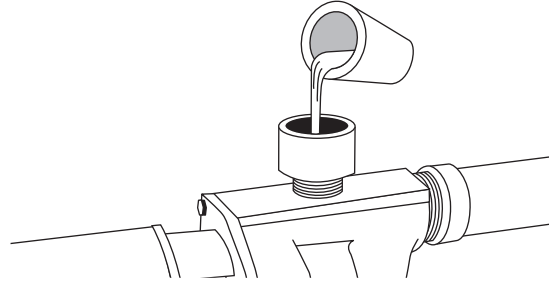

Español - Preparar la bomba para reiniciar

STEP 14 After pump is cold, push reset button until it locks into place

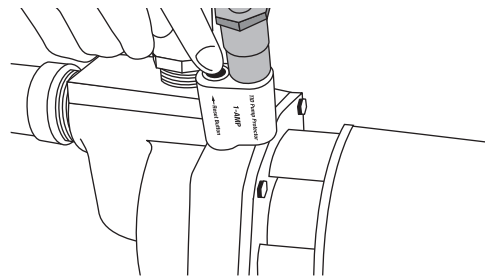

Español - Después de que la bomba esté fría presione el botón de reinicio hasta que encaje

STEP 15 Restore main power and confirm pump operates properly

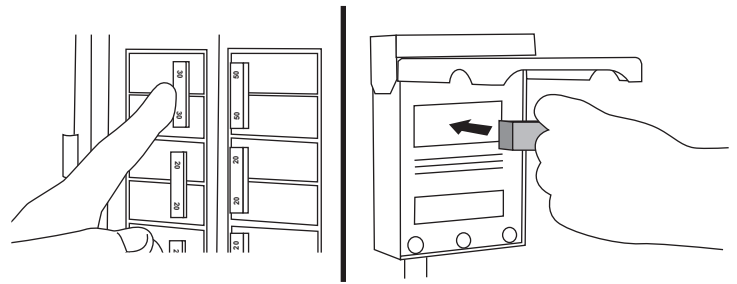

Español - Restaurar electricidad a la bomba y confirmar el funcionamiento correcto

For warranty information and more detailed instructions on this and other models of the TID Pump Protector, please visit our website at www.thermalinterrupt.com or contact us by phone at (801) 477-PUMP